

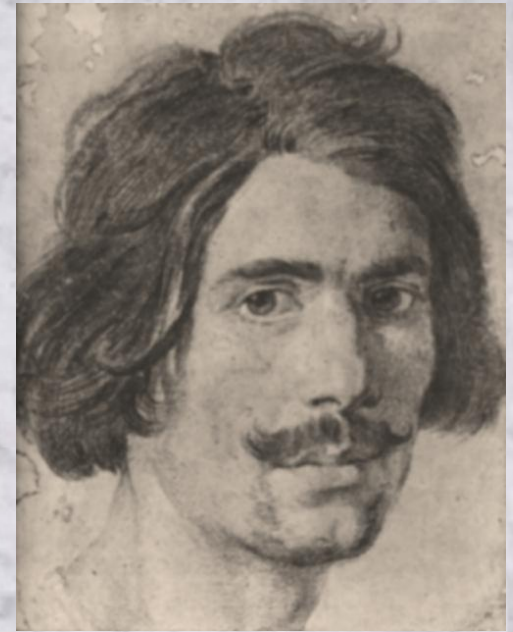

BORROMINI & BERNINI



PROF. CHRISTOPHER LOBAS



FRANCESCO BORROMINI

BORN:
TICINO, 1599

DIED:
ROME, 1667

SCHOLAR, ARCHITECT,
MATHEMATICIAN,

USED CONCAVE & CONVEX
SURFACES TO CREATE MOTION

BIPOLAR MANIC AND
MELANCHOLIC.

DEATH WAS BY SUICIDE:
HE FELL ON HIS SWORD

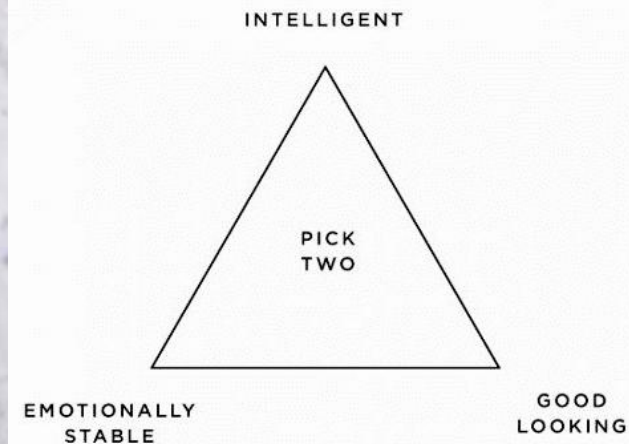



GALLERIA SPADA

1632, ROME. UTILIZES
FORCED PERSPECTIVE –

THE CORRIDOR IS
26' LONG, APPEARS 121'

THE SCULPTURE IS
3' TALL, BUT APPEARS 6'





SAN CARLO ALLE QUATTRO FONTANE

1638-41

BORROMINI'S
BAROQUE
MASTERPIECE





SAN CARLO ALLE QUATTRO FONTANE

1638-41

BORROMINI'S
BAROQUE
MASTERPIECE



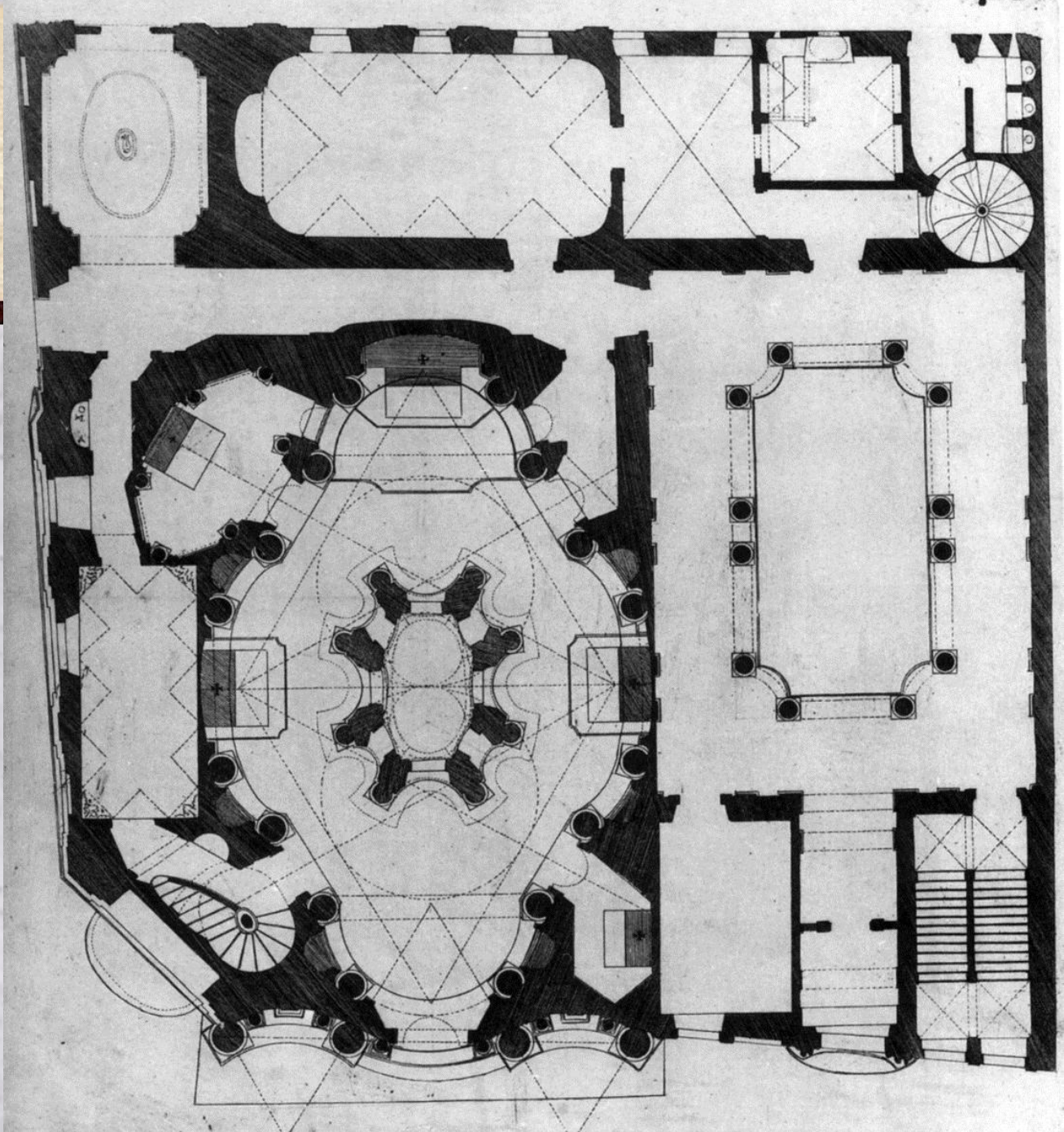
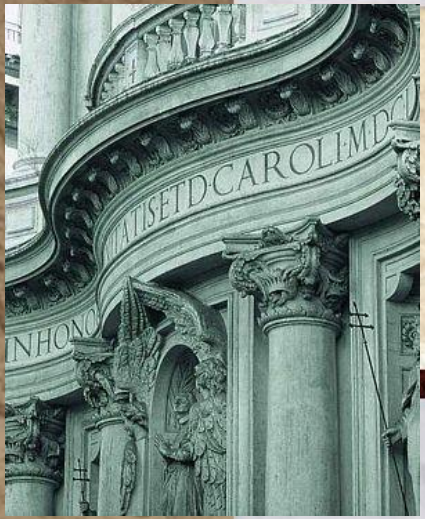



SAN CARLO ALLE QUATTRO FONTANE

1638-41

BORROMINI'S
BAROQUE
MASTERPIECE



SAN CARLO ALLE QUATTRO FONTANE

1638-41

DEDICATED TO
ST. CHARLES
BORROMEO
AND THE HOLY
TRINITY



SAN CARLO ALLE QUATTRO FONTANE

1638-41

BORROMINI'S
BAROQUE
MASTERPIECE

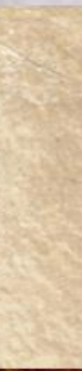

SAN CARLO ALLE QUATTRO FONTANE

1638-41

BORROMINI'S
BAROQUE
MASTERPIECE



OBERLIN COLLEGE HALL AUDITORIUM

1953, WALLACE HARRISON NOTE UNDULATING WALL





OBERLIN COLLEGE HALL AUDITORIUM



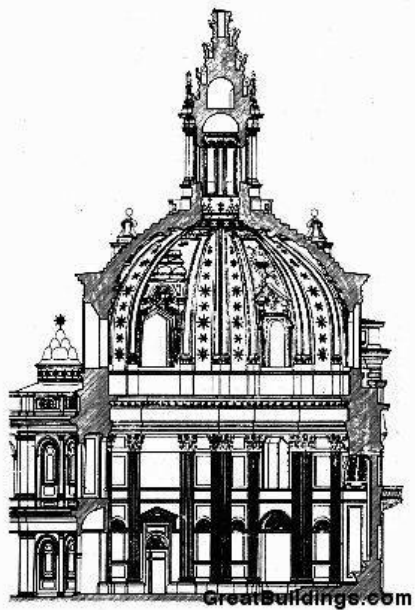

IVO DELLA SAPIENZA

1642 - 1650



IVO DELLA SAPIENZA

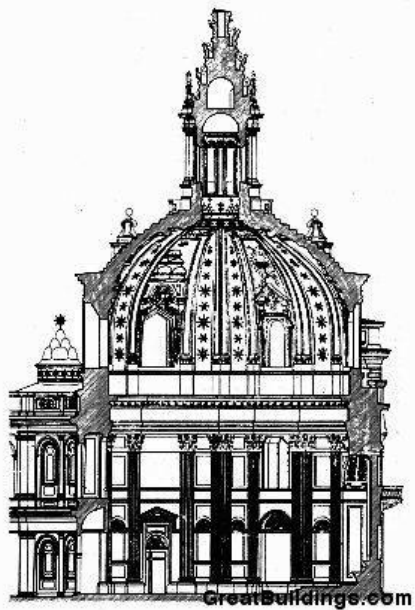

IVO DELLA SAPIENZA

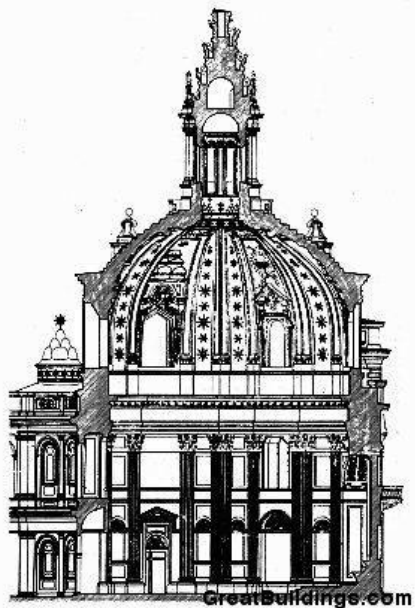

GIAN LORENZO BERNINI

BORN:
NAPLES, 1598
DIED:
ROME, 1680

ARCHITECT, PAINTER,
SCULPTOR, COMPOSER,
PLAYWRIGHT

FOUNTAINS, PALACES,
CHURCHES, PIAZZA

WORKED FOR LOUIS
XIV IN FRANCE



APOLLO & DAPHNE



DAVID





SAINT PETER'S SQUARE & BASILICA

SCHEME: BRAMANTE (1506), RAPHAEL (1515), SANGALLO (1520)
MICHELANGELO (1547), CARLO MODERNO (1602)



PIAZZA DI SAN PIETRO – BERNINI (1656 – 1667) BAROQUE



448 FEET – TALLEST
DOME IN THE WORLD
INSPIRED BY
PANTHEON AND
FLORENCE DUOMO





BALDUCCINO

TALLER THAN A
TEN-STORY
BUILDING

SOLOMONIC
COLUMNS WITH
CARVED VINES,
LEAVES, BEES



TOP OF ALTAR

INTRICATE
CARVINGS

LAYERED CLASSICAL
ELEMENTS

SCULPTURE AND
LIGHT COMPOSED



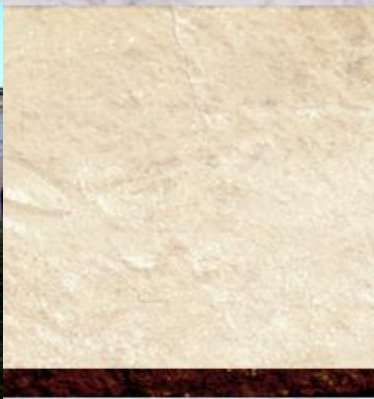

SANT ANDREA AL QUIRINALE

THE CHURCH OF
SAINT ANDREW'S AT
THE QUIRINAL

1658-1670

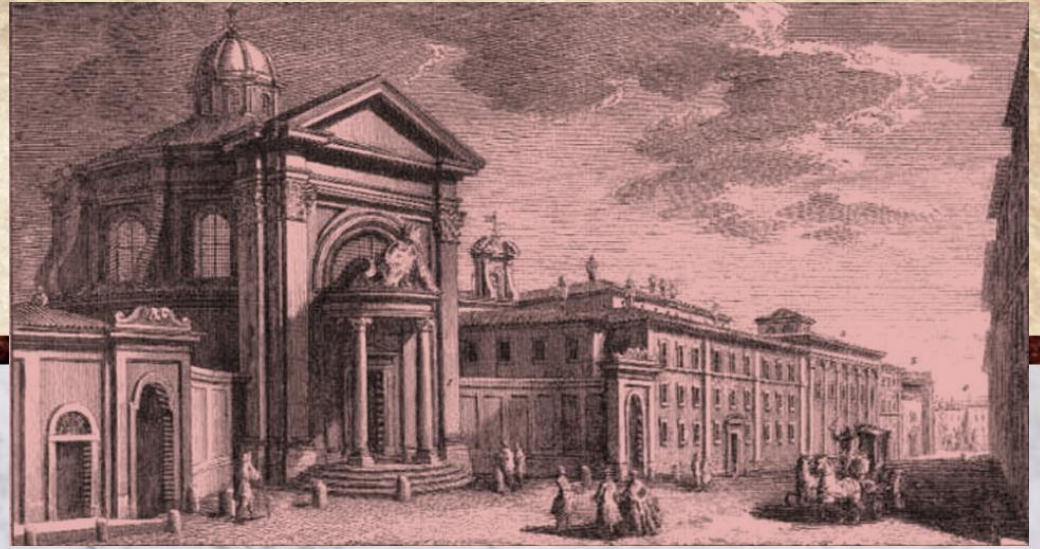

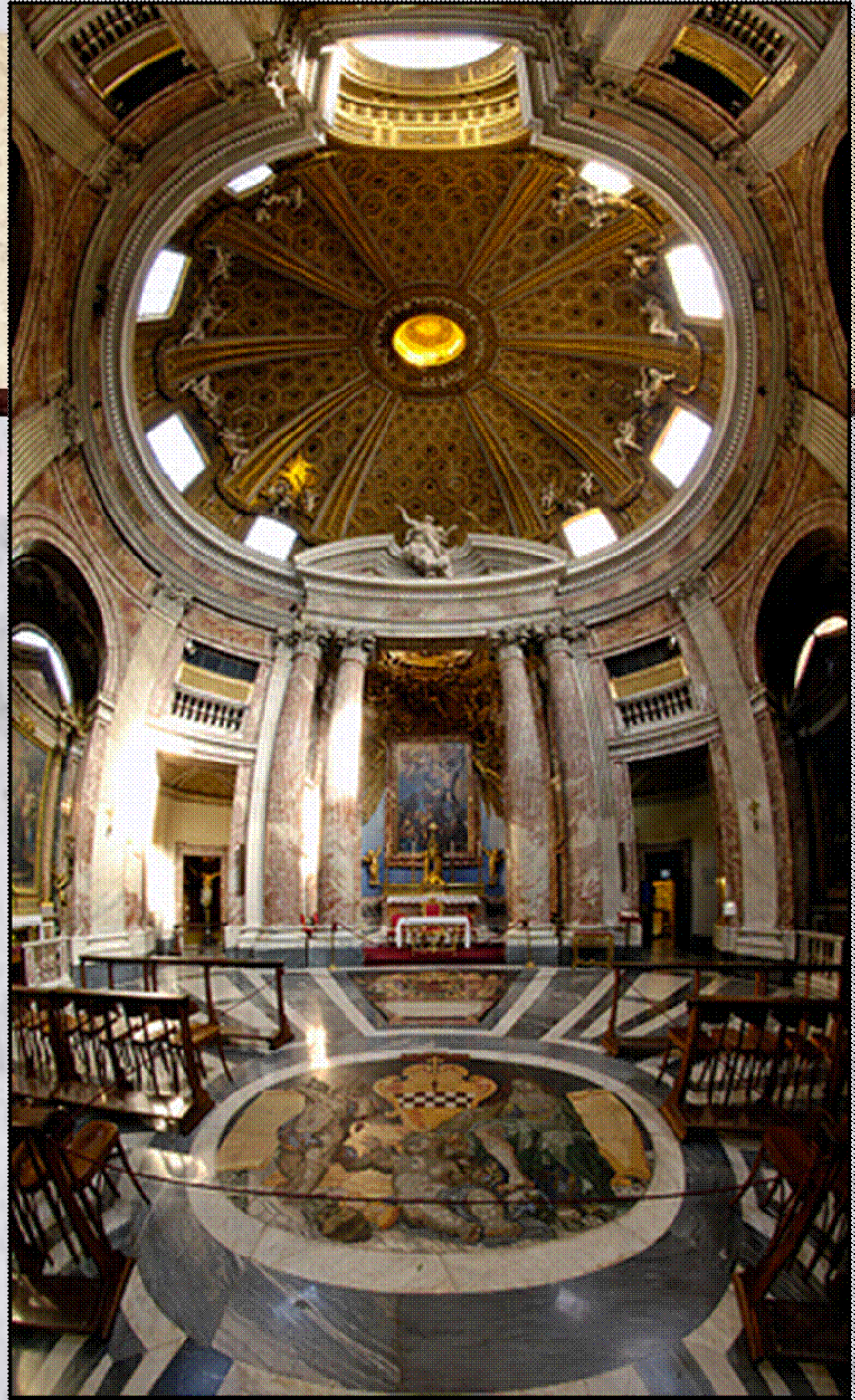

SANT ANDREA AL QUIRINALE

THE CHURCH OF
SAINT ANDREW'S AT
THE QUIRINAL

1658-1670

SANT ANDREA AL QUIRINALE



SANT ANDREA AL QUIRINALE

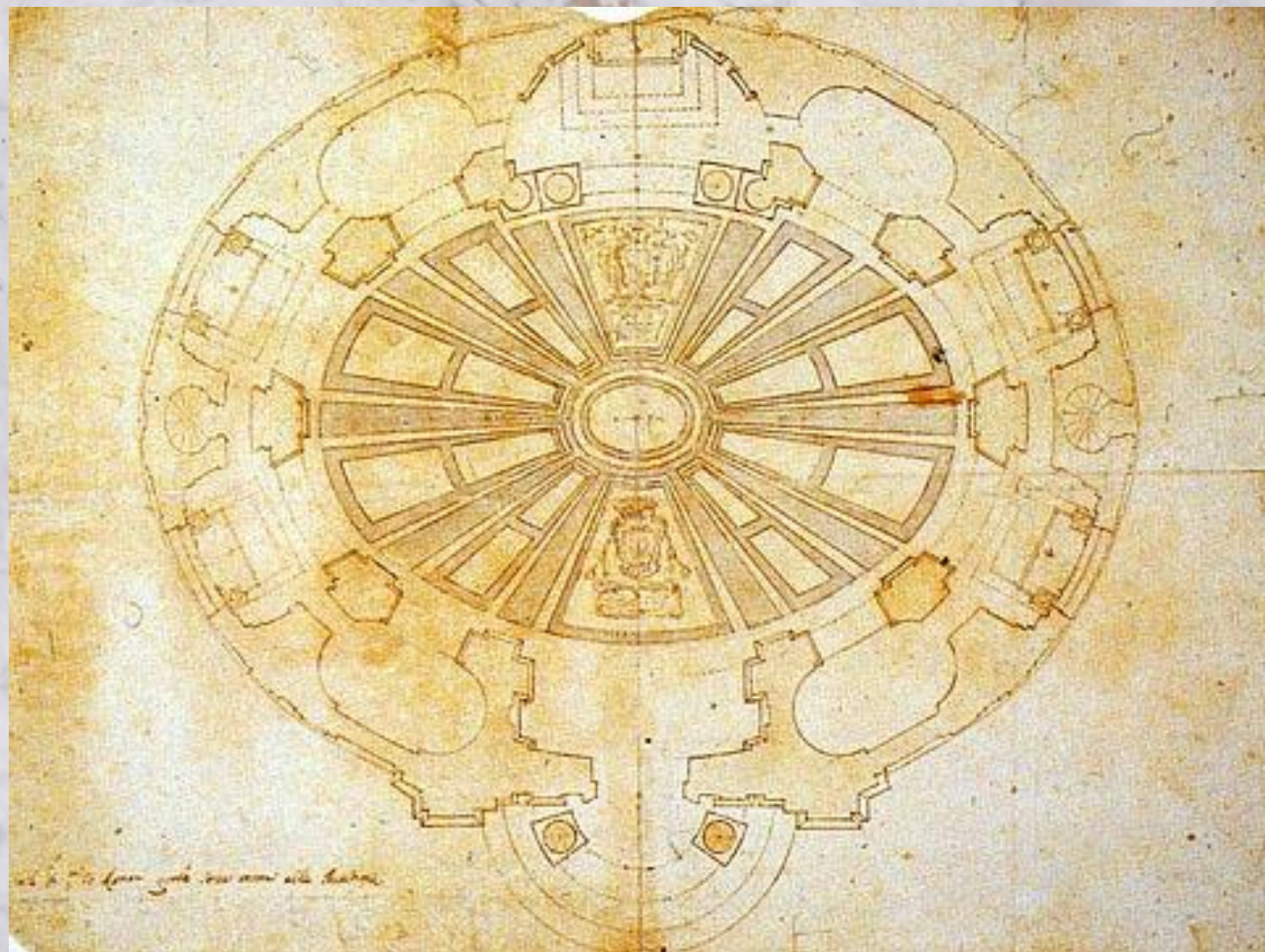







ECSTASY OF SAINT TERESE

SANTA MARIA
DELLA VITTORIA

1647 TO 1652

PENCIL SKETCH
BY PROFESSOR LOBAS





SAINT TERESE

SANTA MARIA
DELLA VITTORIA

1647 TO 1652

